

**GT**

**QUICK START GUIDE**  
**BMX**

**MODELS**

All GT bikes with a Gyros



# WELCOME TO THE GT FAMILY

Ok, let's get to the point.... We want to get you out riding your new GT. Our simple assembly process makes it possible to use your skills to assemble your GT on your own, and it's even easier to do with a friend. This guide will walk you through the steps, and you can also follow along with a video as you build your bike, **visit: [help.gt bicycles.com](http://help.gt bicycles.com)**

Still have questions? GT rider support staff are ready to help you. Feel free to give 'em a ring at **(800) 245-3872** a great source of help is at your local GT retailer or other professional bicycle retailer.

Don't forget to tag #gt bicycles in your social media when your new bike is all assembled and ready to ride. We can't wait to check it out.



This is a Quick Start Guide, intended to accompany the assembly video, not an Owner's manual.

Bicycling is an active sport with inherent risk. A wide range of injuries are possible. Due to the nature of bicycle riding, the situations you encounter while riding, you will be exposed to the risk of serious injury, paralysis or death. This risk cannot be eliminated. You can minimize the risk in many ways. Begin by reading the complete GT Bicycle Owner's manual accompanying this bike and available online at [www.gt bicycles.com](http://www.gt bicycles.com).

# GETTING YOUR BIKE READY FOR ASSEMBLY

- + This assembly video applies to all Gyro- equipped GT kids bikes
- + No tools are required for this assembly, aside from your own two hands.
- + The Gyro is the assembly that enables the handlebar and stem to rotate fully without causing the brake cables to wrap around the head tube of the bicycle.

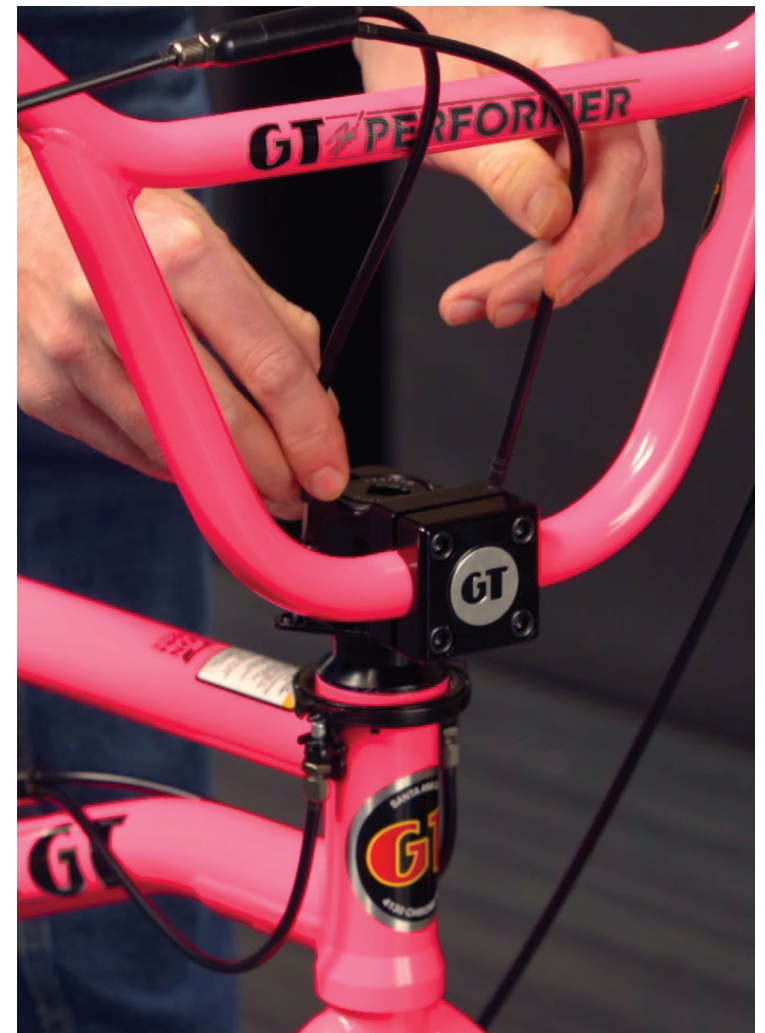

# ***KEY PARTS OF THE BIKE REFERENCED IN THIS GUIDE***



**GYRO**

# GYRO SETUP

1. Locate the dual brake cables and thread them through the middle of the handlebar, placing one cable on each side of the stem.
2. Install one cable through the hole and lightly tighten the nut, then slide the cable guide into place.
3. Lift up the collar and slide the end of the cable into it. Repeat the process on the other side of the stem.

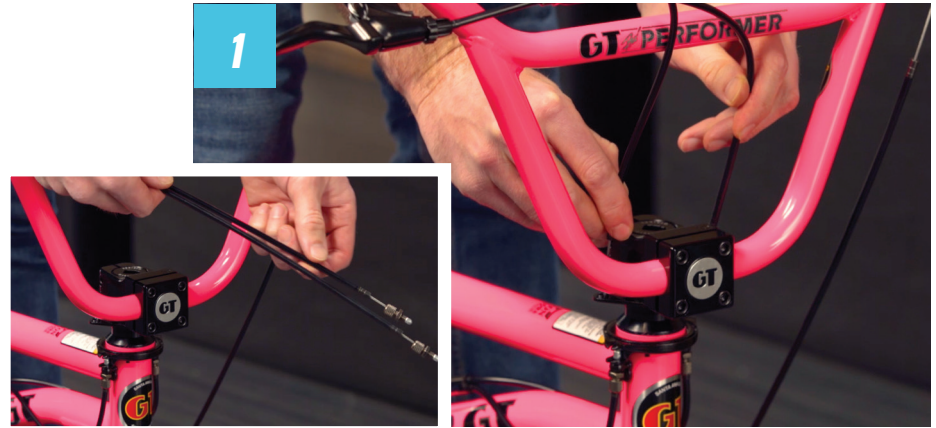

# GYRO SETUP

4. Verify the space between the gyro and stem is even all the way around. If it's not, use the barrel adjusters on the top and bottom to loosen or tighten the appropriate cables to balance the gap.
5. Tighten down the barrel adjuster lock nuts, then give the bar a spin to ensure there's no noise, binding or movement.

*CONGRATULATIONS!*  
***YOU HAVE ASSEMBLED  
THE GYRO.***  
*HAVE FUN!*



# OUR STORY

Since 1972 GT Bicycles has proudly been developing bikes, for every type of rider, with a consistent mission. That mission is the same reason everybody throws a leg over their very first bike – pure fun, plain and simple. GT Bicycles remains true to sharing the stoke on two wheels which the brand was founded on because, after all, you can't have Good Times without 'GT'!

*FOLLOW US ON*   

@gtbicycles / @gtbmxfreestyle



